

HelpAge Network

Asia/Pacific Regional Conference 2014

# Older People in Ageing Societies: Burden or Resource?



**Welcome**

## **HelpAge Network Asia/Pacific Regional Conference 2014**

### **“Older people in Ageing Societies: Burden or Resource?”**



Welcome to the HelpAge Network Asia/Pacific Regional Conference 2014, held in the beautiful city of Chiang Mai, Thailand. This Conference provides us with a unique opportunity to discuss the problems and possibilities that the large and rapid demographic transition presents to our region.

The message of the Conference is “Unlocking potential in later life” and it encapsulates our vision for the 21st century. By stepping away from the common and simplistic perception of older people as a burden, we may find innovative strategies, policies and programmes to engage older people in economic, social and environmental development. And in doing so, we also alter the way societies perceive themselves.

The Regional Conference agenda has been designed to promote a balanced view, not looking at the next two or three years or even ten years, but rather with the perspective of the next generations.

We are holding this Conference in strong partnership with the UNFPA, which is a key promoter of progressive policies on population and ageing, and with the kind support of the European Union.

We also recognise the collaboration of the Faculty of Nursing at Chiang Mai University, the Foundation for Older People’s Development, the Ministry of Social Development and Human Security, and the Senior Citizen’s Council of Thailand, without whom this event would not be possible.

We hope you find this Conference stimulating and useful, and we hope you enjoy your time with us in Thailand.

A handwritten signature in blue ink, appearing to read 'Eduardo Kliem'.

Eduardo Kliem  
Regional Director, East Asia/Pacific  
HelpAge International

# Programme

**Monday 1 September 2014**

08:00 – 08:45 Late registration

---

## **Morning plenary session**

09:00 – 09:50 Welcome, introductions and opening speeches

09:50 – 10:10 Group photograph

*10:10 – 10:45 Refreshments and networking*

10:45 – 11:15 **Framing the Conference**

**Older people as a resource: Redesigning societies**

Mr Eduardo Klien, Regional Director, East Asia/Pacific, HelpAge International

11:15 – 12:00 **Keynote Address**

**Older people as a resource: The precondition of healthy ageing**

Hon Dr Keizo Takemi, MP, Japan

12:00 – 12:10 Announcements

*12:10 – 13:25 Lunch and networking*

---

## **Afternoon plenary session**

13:25 – 13:35 **The evolving role of older people in Indonesian families: Personal reflections**

Ms Eva Sabdono, Executive Director, Yayasan Emong Lansia, Indonesia

13:35 – 14:20 **Rethinking older people as an economic resource in ageing societies**

Mr Philip O’Keefe, Lead Economist, Social Protection and Labour, World Bank, Australia

14:20 – 15:05 **Perceptions of older people in society and the media**

Mr Nalaka Gunawardene, Executive Director, TVE Asia Pacific, Sri Lanka

15:05 – 15:20 Explanation of small group sessions and parallel sessions

*15:20 – 15:50 Refreshments and networking*

---

## **Open dialogue breakout sessions**

15:50 – 17:00

- **Healthy older people in ageing societies: an open dialogue**  
Moderator: Ms Lubna Baqi, UNFPA Asia Pacific Regional Office

- **Older people as an economic resource: an open dialogue**  
Moderator: Mr Eduardo Klien, HelpAge International

- **Perceptions of older people in society and the media: an open dialogue**  
Moderator: Ms Anne Harmer, UNFPA Asia Pacific Regional Office

---

*19:00 onwards Welcome dinner, co-hosted by the Faculty of Nursing, Chiang Mai University*

**Tuesday 2 September 2014**

08:30 – 08:55 Final sign-up for parallel sessions

---

### Parallel sessions: Round 1

- 09:00 – 10:30
- **Should flexible retirement be promoted?**
  - **Older people in community development: Mobilisation, empowerment and scale-up**
  - **Ageing in the Post 2015 agenda: An opportunity for inclusion**

*10:30 – 11:00 Refreshments and networking*

---

### Parallel sessions: Round 2

- 11:00 – 12:30
- **Older people in the informal sector: Unrecognised workers**
  - **Active older people in emergencies and disaster preparedness**
  - **How can we involve older people in healthy ageing? Challenges, priorities and roadmap**

*12:30 – 13:30 Lunch and networking*

---

### Parallel sessions: Round 3

- 13:30 – 15:00
- **Who is farming the land? The ageing of farm populations and its implications for policy and practice**
  - **The contribution of older volunteers in ageing societies: The case of China**
  - **How elders contribute to the household and family**

*15:00 – 15:30 Refreshments and networking*

---

### Afternoon plenary session

15:30 – 17:00 **Panel discussion: Priorities for unlocking potential in later life**  
Moderator: Mr Philip O'Keefe, World Bank

---

### UNFPA publication launches

- 17:15 – 18:15
- **Indonesia in the Threshold of Population Ageing**  
Mr Richard Makalew, UNFPA Indonesia
  - **Population Ageing in the Pacific Islands: A Situation Analysis**  
Mr Andreas Demmke, UNFPA Pacific Sub-Regional Office

## Wednesday 3 September 2014

09:00 – 10:15	Summary of outcomes from parallel sessions
<i>10:15 – 10:40</i>	<i>Refreshments and networking</i>
.....	
10:40 – 11:20	<b>The care experience of the network since Regional Conference 2012 in Yangon</b> Ms Usa Khiewrord, HelpAge International
	<b>What is community care? Care context and key issues</b> Professor Tine Rostgaard, Aalborg University, Denmark
11:20 – 12:30	<b>Panel discussion: Connecting stakeholders to expand community care</b> Moderator: Mr Srinivas Tata, UNESCAP
<i>12:30 – 13:40</i>	<i>Lunch and networking</i>
.....	
13:40 – 14:00	<b>The network towards the future</b>
14:00 – 15:15	<b>Panel discussion: From network to movement – Collaborating to redesign societies</b> Moderator: Mr Chris Roles, Age International, UK
15:15 – 15:30	<b>Closing remarks</b>
<i>15:30 – 16:00</i>	<i>Refreshments and networking</i>
.....	
<i>18:45 onwards</i>	<i>Farewell dinner, hosted by HelpAge International</i>

## Thursday 4 September 2014

08:00 – 14:30	<b>Field visits</b> Participants to choose 1 location from 4 options <ul style="list-style-type: none"><li>• Sanpatong</li><li>• Saraphi</li><li>• Banthi</li><li>• Doi Saket</li></ul> For more information on field visit locations, please see page 10.
---------------	---

# Speaker information

## Keynote speaker



**Hon Dr Keizo Takemi, MP, Japan**

Hon Dr Keizo Takemi is a Liberal Democratic Party (LDP) member of the Japanese House of Councillors and serves as Chairman of the Investigation Committee on Governing Structure of the House of Councillors, and as Deputy Chairman of the LDP's General Council. He served as State Secretary for Foreign Affairs in 1998–1999, and was Senior Vice Minister of Health, Labour and Welfare in 2006–2007.

In the global health field, he has been involved in various initiatives including as a Champion of the Global Health Workforce Alliance since 2010, and as Chair of Asian Forum of Parliamentarians on Population and Development since 2013.

## Master of Ceremonies



**Dr Dharmapriya Wesumperuma, Social Protection Advisor for the Ministry of Social Welfare, Relief and Resettlement, Republic of the Union of Myanmar**

Dr Wesumperuma is an expert in ageing, development and social protection. He has a PhD in History from the University of London.

After 18 years as Executive Director of the Sri Lanka Foundation, Dr Wesumperuma became the Senior Strategy Adviser and Regional Head of Programmes, East Asia/Pacific, for HelpAge International.

## Plenary speakers



**Mr Philip O'Keefe, Lead Economist, Social Protection and Labour, The World Bank, Australia**

Philip O'Keefe is Lead Economist in the Social Protection and Labour Global Practice at the World Bank. He is currently leading the East Asia Pacific regional flagship on Ageing.

Previously, he was Sector Coordinator for Human Development for China in Beijing, leading work on social security, labour and human development issues, and was based in India as social protection coordinator. This followed a decade of work on social security, labour and social services in transition countries of the former Soviet Union and Eastern Europe. Philip holds degrees from University of Sydney, the London School of Economics and Political Science, and Oxford University.



**Mr Nalaka Gunawardene, Executive Director, TVE Asia Pacific, Sri Lanka**

Trained as a science writer, Nalaka Gunawardene has more than 25 years of experience in journalism and communication. In this time, he has worked in mainstream print and broadcast media, as well as with the development community in Sri Lanka and at Asian regional level.

In 1996, Nalaka co-founded TVE Asia Pacific, a not-for-profit media foundation engaged in communicating development via TV, video and web. Nalaka has also worked as a communications consultant for international organisations such as UN-ESCAP, UNEP, UNDP and Asian Development Bank. He is an active blogger, op-ed essayist and journalist trainer.



**Mr Eduardo Klien, Regional Director, East Asia/Pacific, HelpAge International**

Eduardo Klien has more than 25 years experience in social and economic development. He graduated in International Management and Political Science from universities in the Netherlands and the USA, and obtained a MSc in Economics from El Colegio de México.

Eduardo has worked as Senior Adviser in the Ministry of Planning in Nicaragua and for Oxfam as Regional Manager for the Horn of Africa and Regional Director for Mexico/Central America.

In 1997 Eduardo was appointed as a Visiting Research Fellow in the Department of International Development at the University of Oxford, and in 2007 he was appointed as a Research Fellow at the Oxford Institute of Population Ageing, also at the University of Oxford. For the last 15 years Eduardo has been living and working in Asia, holding different directive positions in Laos, Vietnam and regionally.



**Ms Eva Sabdono, Executive Director, Yayasan Emong Lansia, Indonesia**

Eva Sabdono has extensive experience in the business world, both in her native Jakarta and overseas, and she counterbalances the business life with activism in social development. Over the past 15 years, after joining Yayan Emong Lansia, where she currently serves as Executive Director, Eva has developed an international reputation for her passion to improve care conditions for older Indonesians. She is an active member of the Women's International Club, ASEAN Women's Association, Alzheimer's Indonesia and the Indonesia Gerontology Association, to name but a few.



**Ms Usa Khiewrord, Regional Programme Manager, HelpAge International**

Usa Khiewrord has over 20 years experience in community and social development and ageing. At HelpAge, Usa works to promote improvement in aged care, with a focus on ASEAN countries. She worked closely with HelpAge Korea in the implementation of the ROK-ASEAN Home Care for Older People project in ten ASEAN countries, and continues to provide technical support to HelpAge Korea in implementation of the new project on community-based services for older people in Cambodia, Laos, Myanmar and Vietnam.

Usa is also a regional focal point on social protection for HelpAge, promoting income security in old age through advocacy for improvement and expansions of social protection and pensions for older people. Usa holds degrees in Social Development and Social Work, and a MSc in Gerontology from King's College, London.



**Professor Tine Rostgaard, Aalborg University, Denmark**

Tine Rostgaard is Professor at the Department of Political Science, Centre for Comparative Welfare Studies (CCWS), Aalborg University. She holds a PhD in comparative social care. Her research contributions has mainly been to the field of social care for children and elderly, and more specifically to the understanding of care regimes, family obligations, welfare mix, consumerism in care and quality in care. She has acted as regional expert for HelpAge International in Asia in the comparative study of community based care. She has also recently headed a comparative European project on reforms in home care for elderly (LIVINDHOME).

# Parallel session overviews

## **Should flexible retirement be promoted?**

What are the alternatives to a fixed retirement age? This session will discuss different options for retirement, including extensions of retirement ages and flexible retirement, and their implications, and provide recommendations for action in this area.

## **Older people in community development: Mobilisation, empowerment and scale-up**

Despite impressive localised examples of community mobilisation of older people, challenges remain in 'scaling up' from these examples. This session will give an overview of different approaches taken to scale up and identify some common barriers and how these can be overcome. The session aims to articulate some recommendations for both policy makers and practitioners working in communities about how to maximise the resources available from older people for local development.

## **Ageing in the Post 2015 agenda: An opportunity for inclusion**

This session will reflect on the progress made to date to include older people in the post 2015 agenda. With the Sustainable Development Goals nearing formalisation, this session will reflect on how they can not only cover the vulnerabilities of older people but also support the creation of enabling environments to maximise older people's economic and social contributions.

## **Older people in the informal sector: Unrecognised workers**

Does society encourage or discourage people from earning income in old age? How can we maximise the contribution of older people? Many people continue to work into later life in the informal sector, and face different challenges which affect their productivity and quality of life. How will this impact the labour force in the future? This session will discuss the context and situation of work in old age in the informal sector.

## **Active older people in emergencies and disaster preparedness**

What is the implication of longevity, health and education on the role of older people in emergency response and disaster risk reduction? How can society increase the potential of older people to contribute to emergency responses and disaster preparedness for the benefit of entire

communities? This session will look at some of the activities older people are already involved in and ideas for their increased participation in the future.

## **How can we involve older people in healthy ageing? Challenges, priorities and roadmap**

Mixed progress has been made on healthy ageing, particularly on involving older people in the process. This session aims to identify the gaps and challenges in the region on healthy ageing, and identify and emphasise older people's roles in healthy ageing. Group discussion will focus on priorities and a suggested road map focusing on older people's involvement on healthy ageing.

## **Who is farming the land? The ageing of farm populations and its implications for policy and practice**

What are the challenges and what are the opportunities of an ageing farm population? Is the ageing of the farming population a threat? This session will present evidence on the characteristics and outcomes of older farmers' work. Participants will then debate the challenges and opportunities of an ageing farm population and come up with recommendations for policy and practice.

## **The contribution of older volunteers in ageing societies: The case of China**

The growth in the 60+ demographic is a major community resource that is not fully utilized. One of the ways older people can continue to be active is through volunteerism. This session aims to develop a better understanding of the global human capital of ageing populations and present ideas on some activities in which older volunteers participate in China that could be tried in other countries.

## **How elders contribute to the household and family**

What policies would help older people to make contributions to the family? This session will discuss the practical contributions that older people play at household level and how those contributions can be maximised and supported. The findings of research comparing Myanmar, Thailand and Vietnam will be presented and reflections from community level work in Indonesia will also be shared.



# Floor plan

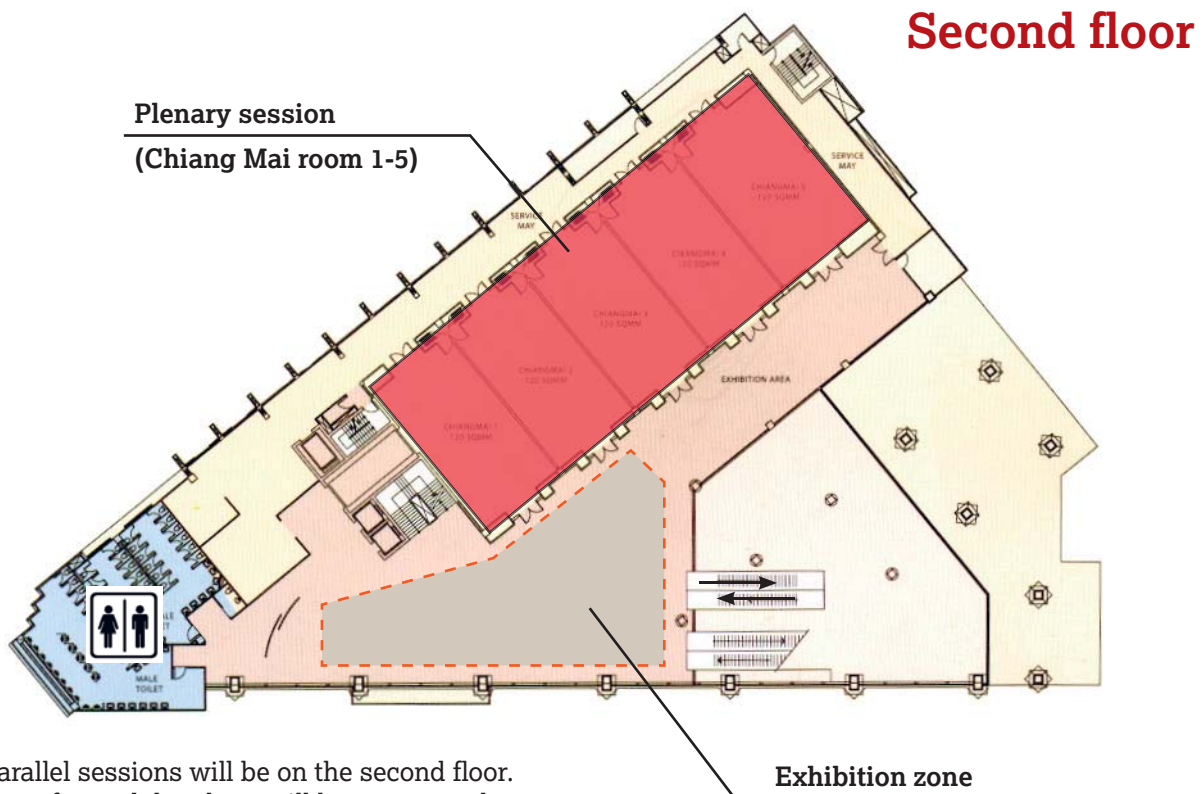
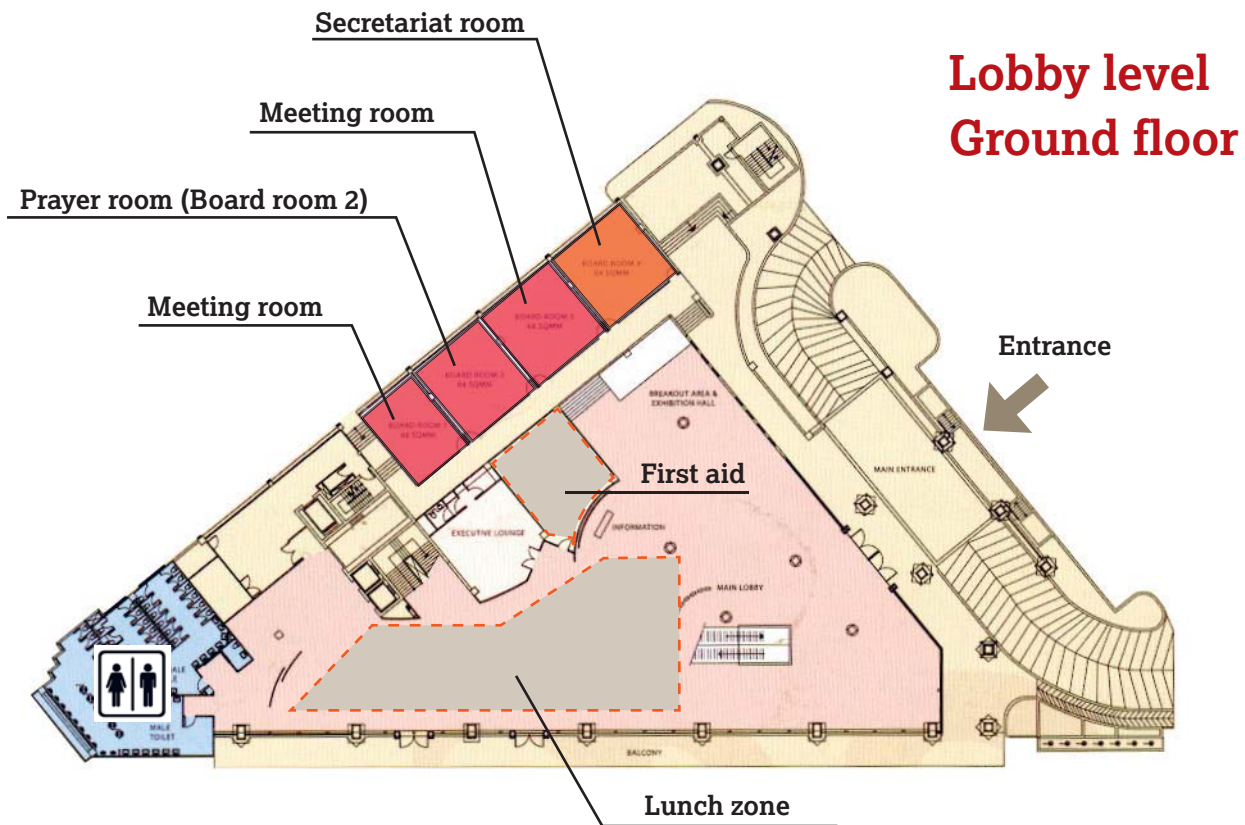

The parallel sessions will be on the second floor.  
The room for each breakout will be announced  
after the plenary session.

## Field visits

### Thursday 4 September 2014, 08:00 – 14:30

There are four options for delegates for field trips. More information on each field trip option will be available at the registration desk and outside the main plenary room on Day One of the Conference. Delegates wishing to join the field visit must sign up to one option by **6pm on Monday 1 September**.

#### Sanpatong : The community learning centre and participation of older people



Mrs Srinuan Manopunya

Delegates will visit the community learning centre in Ban San Gorget, a village in Sanpatong district, Chiang Mai, where older people, led by Mrs Srinuan Manopunya, have actively participated in and contributed to its activities to serve the community.

On this field visit, delegates will learn about one of the centre's key local development activities – the development of local enterprises processing agricultural products and managing the associated waste. Delegates will also have the opportunity to learn about mobilising community support to help frail older people through home-based care run by older persons' groups, and a community savings group which enhances welfare in the community.

#### Saraphi : Traditional medicine, income generation and older people's groups

This field visit will take delegates to visit the older people's group in Thawangtan village, Saraphi district, Chiang Mai, which is a member of the Senior Citizen's Council of Thailand (SCCT). The group has been recognised for its continued efforts to support its members and the wider community.

The group will share information about their activities with delegates, focusing on their traditional medicine group which has proved very popular in the district, and their community cooperative shop that provides job opportunities and income to the group's members. The group will also present their local learning centre for older people, known as the 'University for Older People', which is a new initiative that aims to increase learning opportunities and maximize the potential of older people.

#### Banathi : Community-based care and older people's groups

The Banathi Older People's Group was established to help older people in the community who are caring for their children who are HIV positive. Since 2011 the group has been supported by Banathi hospital to provide information about caring for older people. Local authorities also provide funding to the group for home visits to older people and people in need.

Delegates on this field trip will learn how the group works together with local organisations to arrange financing for older people's care and to organise activities for older people, including vocational training and social activities.

#### Doi Saket - Older people leading the way in organic farming

In Doi Saket district, delegates will visit the organic farm of Mr Boonchuay Boonyen, 66, the local leader of an organic farming network. Mr Boonchuay and a local NGO leader, Mr Kaittisak, will talk to delegates about making the switch to organic farming, how the network works to support members and the community, and how older people in the district are leading the way in this kind of agriculture. Delegates will also have the opportunity to tour the farm and Mr Boonchuay's vegetable gardens.



Mr Boonchuay

# Practical information

## Join in the discussion

We value your contribution and encourage you to participate in the discussions of the Conference. Please follow the HelpAge East Asia/Pacific Regional Office @HelpAgeEAPRO on Twitter and tweet your thoughts and comments using the hashtag #HelpAgeAP14.

## Mobile phones

As a courtesy to the speakers and other delegates, please switch your mobile phones to silent while the Conference is in progress.

## Lunch and refreshments

A buffet lunch will be served on the ground floor of the Empress Convention Centre on each day of the Conference. Lunch and break during the field visit will be provided.

Vegetarian buffet choices and Halal food are available every day. If you have notified us of any special dietary requirements, please speak to a member of staff on duty in the dining area.

Morning and afternoon refreshments will be served directly outside the main plenary room.

## Prayer room

Boardroom 2 on the ground floor of the Empress Convention Centre is designated as a prayer room for the duration of the Conference. Please speak to a member of staff on the registration desk if you have any questions.

## Wi-Fi

Wireless internet is available throughout the Empress Convention Centre. The code will be distributed each day in the first session.

## Photography and filming

Please note that some parts of the conference will be filmed and there will also be photographers present. Photographs and conference commentary will be shared on social media throughout the conference. If you would prefer for us not to film or photograph you, please speak to a member of the communications team at the registration desk.

## Dress code

A group photo will be taken in the morning of **Monday 1 September**, so please wear formal dress on the first day of the Conference and smart casual on following days.

## Identification

For identification and security reasons, all participants are requested to wear their badges at all times during the Conference. The loss of a badge should be reported to the Secretariat, so that a new one can be issued immediately.

## Illness or injury

HelpAge, in collaboration with Faculty of Nursing Chiang Mai University, will make available first aid facilities in first aid room on the ground floor of the Empress Convention Centre. A trained nurse will be on standby during the hours of the conference. If you become unwell at any stage during the Conference, please notify the Secretariat immediately.

## HelpAge International website

Please visit our global website [www.helpage.org](http://www.helpage.org) for more information about our work and our global network.

# Unlocking potential in later life

**HelpAge International**  
**East Asia and Pacific Regional Office**  
6 soi17, Nimmanhemin Road, Suthep  
Muang, Chiang Mai 50200, Thailand  
Tel: +66 53 225 440  
Fax: +66 53 225 441  
[hai@helpageasia.org](mailto:hai@helpageasia.org)  
[www.helpage.org](http://www.helpage.org)  
[www.ageingasia.org](http://www.ageingasia.org)

Collaborating organisations

